



First choice when  
quality counts.™

# President and Monark Airless Spray Cart Packages

- **Package solutions to fit your applications**
- **Completely assembled, ready to spray**
- **Severe Duty CST and Severe Duty full SST models available**
- **Featuring the Silver Plus™ airless spray gun for reliability and maximum efficiency**

Graco's President and Monark airless spray cart packages are designed to handle the rugged environment of protective coatings applications, as well as the demanding production needs of the heavy equipment manufacturer. These units are ideal for operations requiring the mobility of a cart-mounted sprayer. They are ready for use right "out-of-the-box," and are equipped with gun fluid hose swivel and whip hoses to provide the operator with maximum comfort and handling ease. These sprayers combine superior Graco pump and gun technology to deliver high performance and trouble-free reliability. Choose our standard Severe Duty or complete SST construction for corrosive coatings. See the back page selection guide to choose the Graco airless spray cart package that's right for your application.

**Engineered  
packaged  
solutions  
designed for  
your airless  
finishing  
application  
needs**

## Typical Fluids Handled

- Shop and wash primers
- High solids topcoats
- High viscosity coatings
- Pre-mixed plural component coatings

## Typical Industry Applications

- Marine
- Rail car
- Farm and construction
- Sheet metal fabrication
- General machinery
- Wood

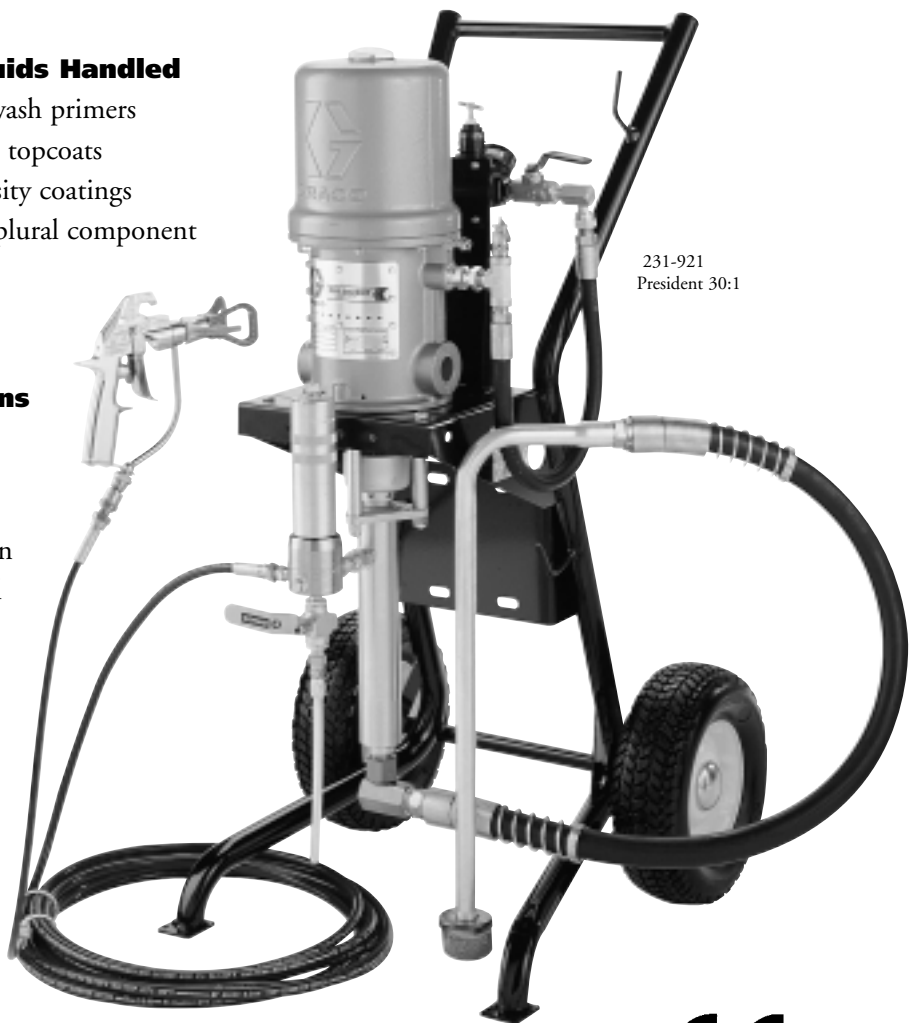

231-921  
President 30:1



# Technical Specifications

- Maximum fluid working pressure**  
**Monark 23:1** ..... 190 bar (19 MPa)  
**President 30:1** ..... 210 bar (21 MPa)  
**President 46:1** ..... 317 bar (31.7 MPa)
- Maximum air input pressure**  
**Monark 23:1** ..... 8 bar (0.8 MPa)  
**President 30:1 & 46:1** ..... 7 bar (0.7 MPa)
- Fluid flow at 60 cpm**  
**Monark 23:1** ..... 1.5 l/min.  
**President 30:1** ..... 3.6 l/min.  
**President 46:1** ..... 2.1 l/min.
- Maximum pump operating temperature** ..... 82°C
- Air inlet size** ..... 3/8 npsm(f)
- Pump inlet size** ..... 3/4 npt(m)
- Fluid outlet size (at fluid filter)** ..... 1/4 npsm(m)
- Weight (approximate)** ..... 39 kg
- Instruction manual** ..... 308-635

# Dimensions

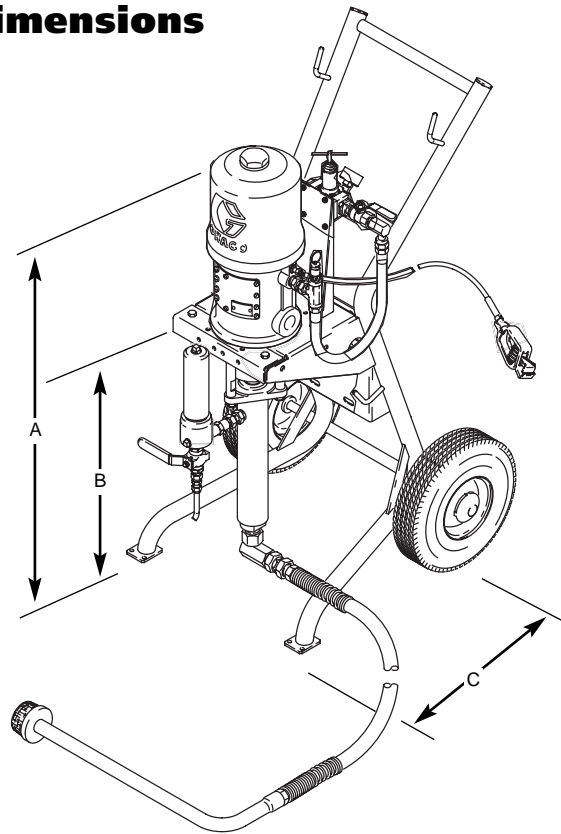

- Dimensions for all Monark and President Models**  
**A** = 978 mm  
**B** = 572 mm  
**C** = 534 mm  
**Width Across Wheels** = 508 mm

# Pump Performance (Performance Curve based on Pump Package)

**Monark 23:1**

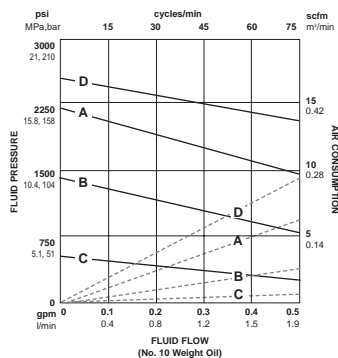

**President 30:1**

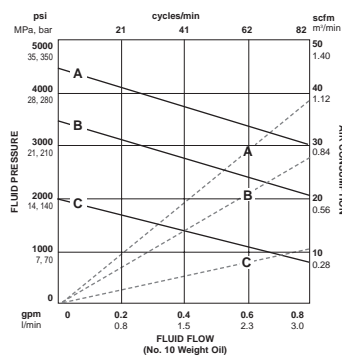

**President 46:1**

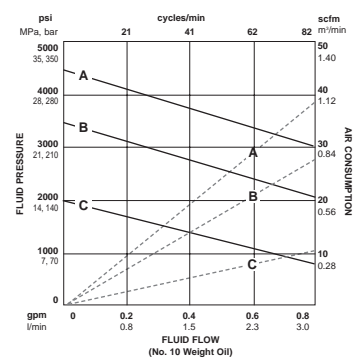

**Key:**  
 — Fluid Outlet Pressure  
 - - - Air Consumption

**Air Pressures:**  
**A** = 7 bar (0.7 MPa)  
**B** = 4.9 bar (0.49 MPa)  
**C** = 2.8 bar (0.28 MPa)  
**D** = 8 bar (0.8 MPa) (Monark 23:1 only)

# Accessories

## Guns

Note: the Monark packages use fine finish, which features a pre-orifice and produce a relatively fine atomization. This is used for lacquers, and low viscosity paints. The President packages use the heavy-duty Reverse-a-Clean tip assembly which is typically used for heavily-filled coatings that are prone to tip clogging.

- 235-462 Silver Plus with DripLess Flat Tip Guard, 0.037" (0.94 mm) Preorifice**  
For fine finish. Spray tip not included. Order separately. See Data Sheet 305-796 for chart.
- 235-464 Silver Plus with HD RAC IV Tip Assembly, and 617 SwitchTip, 2-Finger Trigger**

## Gun Repair Kits for Silver Plus

- 235-474 For 235-460, 235-461, 235-463, 235-464, 238-591**  
Includes diffuser/seat, copper gasket, and needle.
- 235-475 For 235-462**  
Includes pre-orifice seat, copper gasket, and needle.

## Gun Fluid Hose Swivels

- 239-394 Filter/Swivel** 1/4 npt(m) x 1/4 npsm(f)  
Includes 149 micron (100 mesh) element (205-264).
- 205-264 Replacement Filter** 149 micron (100 mesh)
- 205-265 Replacement Filter** 238 micron (60 mesh)
- 189-018 Swivel** 1/4 npt(m) x 1/4 npsm(f)

## Nipples (for Hose)

For connecting main hose to the whip hose.

- 162-453 CST** 1/4 npt x 1/4 npsm
- 166-846 SST** 1/4 npt x 1/4 npsm

## Valves

- 113-916 Relief Valve (for Monark models)**  
Relief pressure: 10.5 bar (1.05 MPa)
- 113-769 Relief Valve (for President models)**  
Relief pressure: 8.6 bar (0.86 MPa)
- 113-333 Bleed-Type Master Air Valve**  
3/8 npt(mxf)
- 238-635 Fluid Drain Valve, CST** 1/4 npt(mbe)
- 239-018 Fluid Drain Valve, SST** 1/4 npt(mbe)

## Filters

- 239-060 CST**
- 239-063 SST**

## Stainless Steel Replacement Screens (3-Packs):

- 238-435** 500 micron (30 mesh)
- 238-437** 238 micron (60 mesh)
- 238-439** 149 micron (100 mesh)
- 238-441** 74 micron (200 mesh)

## Suction Tube Strainers

- 181-073 For CST Models** 1/2 npt(f)
- 183-770 For SST Models** 3/4 npt(f)

## Air Regulators

- 113-764 Air Regulator**  
Max. air inlet pressure: 17.2 bar (1.7 MPa)  
Inlet and outlet: 3/8 npt(f).
- 238-917 Repair Kit** (for 113-764)
- 113-911 Gauge** (used with 113-764)

## Throat Seal Liquid

Non-evaporating liquid for wet cup.

- 206-994 0.5 Litre**
- 206-995 0.9 Litre**
- 206-996 3.8 Litre**

## Air Line Lubricator

Provides automatic lubrication for the air motor.

Requires (1) 113-766 connector.

- 114-005 Lubricator**  
Max. working pressure: 17.2 bar (1.7 MPa)
- 113-766 Connector**  
Attaches lubricator to air regulator assembly.

## Grounding Clamp

- 238-909 Grounding Wire and Clamp**

## Warning Labels

Available at no cost.

- 290-331 English**
- 290-396 German**
- 290-397 French**
- 290-398 Spanish**

## Whip Hose

*Maximum working pressure: 207 bar (20.7 MPa).*

*1/4 npt(m) x 1/4 npsm(f). CST fittings.*

- 236-134** 1/8" (3 mm) x 0.9 m
- 236-135** 1/8" (3 mm) x 1.8 m

*Maximum working pressure: 280 bar (28 MPa).*

*1/4 npsm(fbe). CST fittings.*

- 238-708** 3/16" (4.7 mm) x 0.6 m
- 238-709** 3/16" (4.7 mm) x 1 m
- 238-710** 3/16" (4.7 mm) x 2 m
- 238-822** 1/4" (6.3 mm) x 0.6 m
- 238-823** 1/4" (6.3 mm) x 1 m
- 238-824** 1/4" (6.3 mm) x 2 m
- 239-082** 3/16" (4.7 mm) x 1 m

*1/4 npsm(fbe). SST fittings.*

- 239-069** 3/16" (4.7 mm) x 0.6 m
- 239-108** 1/4" (6.3 mm) x 0.6 m

## Fluid Hose

*Maximum working pressure: 280 bar (28 MPa).*

*1/4 npsm(fbe). CST fittings.*

- 238-711** 3/16" (4.7 mm) x 5 m
- 238-712** 3/16" (4.7 mm) x 7.5 m
- 238-713** 3/16" (4.7 mm) x 15 m
- 238-825** 1/4" (6.3 mm) x 5 m
- 238-826** 1/4" (6.3 mm) x 7.5 m
- 238-827** 1/4" x (6.3 mm) x 15 m
- 238-828** 1/4" (6.3 mm) x 30 m

*1/4 npsm(fbe). SST fittings.*

- 239-107** 1/4" (6.3 mm) x 7.5 m
- 239-110** 1/4" (6.3 mm) x 10 m
- 239-111** 1/4" (6.3 mm) x 15 m

*Maximum working pressure: 345 bar (34.5 MPa).*

*1/4 npsm(fbe). CST fittings.*

- 238-385** 1/4" (6.3 mm) x 7.5 m

## Ordering Information

Note: internal wear parts are SST with heavy chrome plate (Severe Duty). All CST models listed below are Severe Duty but have accessories and fittings in the fluid path that are plated CST.

	Monark 23:1 231-941	Monark 23:1 231-940	Monark 23:1 231-949
Construction	CST	CST	SST
<b>Package Includes:</b>			
Fluid Hose:			
1/4" (6.4 mm) x 7.5 m.	NA	238-826	239-107
Whip Hose:			
3/16" (5 mm) x 0.6 m	NA	238-708	239-069
Silver Plus Airless Spray Gun (Includes tip of choice. Specify size.)	NA	235-462	235-462
Gun Fluid Hose Filter/Swivel	NA	239-394	239-394
<b>Pump Information:</b>			
Bare Pump	223-596	223-596	237-958
Lower Displacement Pump	223-595	223-595	237-959
Rod and Cylinder	SST	SST	SST
Available Packing Kits: (* denotes Standard Packing Kit)			
Leather/Teflon	235-636*	235-636*	237-998*
Teflon	236-724	236-724	236-724
UHMWPE/Leather	223-674	223-674	223-674

	President 30:1 231-922	President 30:1 231-921	President 30:1 231-931	President 46:1 232-025
Construction	CST	CST	SST	CST
<b>Package Includes:</b>				
Fluid Hose:				
1/4" (6.4 mm) x 7.5 m	NA	238-826	239-107	238-385
Whip Hose:				
3/16" (5 mm) x 0.6 m	NA	238-708	239-069	239-083
Silver Plus Airless Spray Gun (Includes tip of choice. Specify size.)	NA	235-464	235-464	235-464
Gun Fluid Hose Swivel	NA	189-018	189-018	189-018
<b>Pump Information:</b>				
Bare Pump	223-586	223-586	223-843	239-140
Lower Displacement Pump	223-587	223-587	223-842	239-145
Rod and Cylinder	SST	SST	SST	SST
Available Packing Kits: (* denotes Standard Packing Kit)				
Leather/Teflon	235-635*	235-635*	NA	NA
UHMWPE/Leather	223-675	223-675	223-675*	NA
Leather/Teflon Backup	NA	NA	NA	239-328*

Graco is registered to I.S. EN ISO 9001.  
Any and all specifications contained herein are subject  
to change without notice.

 GRACO N.V.  
 Slakweidestraat 31  
 B-3630 Maasmechelen  
 Tel: (32) 89 770 700 • Fax: (32) 89 770 777  
 www.graco.com (US) • www.graco.be (Europe)